

C 125-171

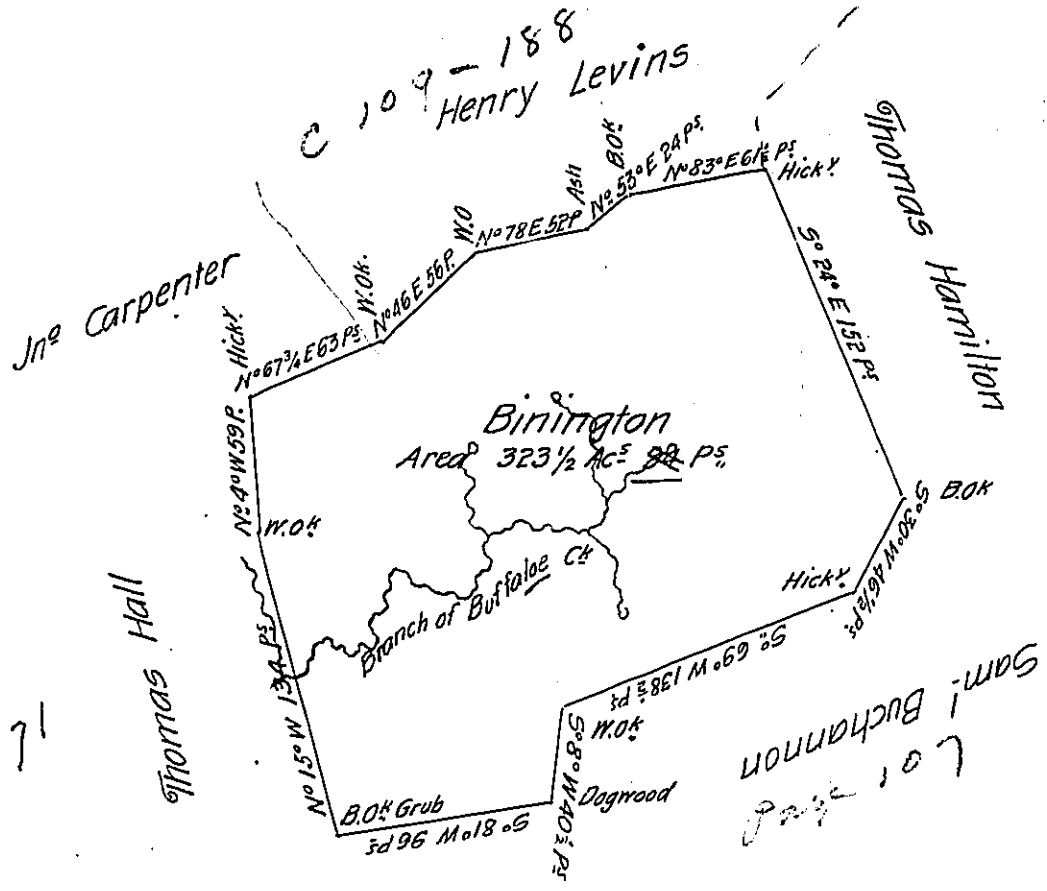

A Draught of a Survey called "Binington" situate on the Waters of Buffalo Cr in Washington County cont^g 323 Ac^s 94 Ps^s strict Measure executed for Tho^s Bines Ass^{ee} of W^m Sparks M^{ch} y^e 25th 1786 in consequence of a Certificate granted to sd W^m Sparks by the Commiss^{es} appointed by Virg^a to adjust the claims to unpatented lands in the counties Monong^a, Yohg^a and Ohio and entered with the County Surv^r y^e 5th of Feb^y. 1780 as appears from the List of Entries transmitted from the Surv^r Gen^{ls} office.

ret^d 18th Jan^y. 1787 & Ent^d 5 Feb^y. 1780

Jno Lukens Esq^r S. Gen^l

Presley Nevill }
Matt^r Ritchie } D. Ss.

IN TESTIMONY that the above is a copy of the original remaining on file in the Department of Internal Affairs of Pennsylvania, made conformably to an Act of Assembly approved the 16th day of February, 1833, I have hereunto set my Hand and caused the Seal of said Department to be affixed at Harrisburg, this fifteenth day of February 1904.

Joseph P. Boring
Secretary of Internal Affairs.